



**COMPOSITE COMPUTER REGISTER
UNDER LAND TRANSFER ACT 1952**



R. W. Muir
Registrar-General
of Land

Search Copy

Identifier **NA81C/431**
Land Registration District **North Auckland**
Date Issued 25 October 1991

Prior References

NA473/88 NA56B/769

Estate	Leasehold	Instrument	L C317674.7
		Term	999 years commencing on the 30th September 1991

Legal Description Flat 4 Deposited Plan 137673

Proprietors

Q Pak Holdings Limited

Estate	Fee Simple - 1/6 share
Area	1186 square metres more or less
Legal Description	Lot 1 Deposited Plan 137673

Proprietors

Q Pak Holdings Limited

Interests

- Fencing Agreement in Transfer 203968 (Affects Fee Simple)
- Appurtenant hereto is a right of way created by Transfer 220534 (affects part) (Affects Fee Simple)
- Subject to a right of way over part marked B on DP 137673 created by Transfer 220534 (Affects Fee Simple)
- C317674.4 Lease of Flat 1 and Garage 1 Composite CT NA81C/428 issued - 25.10.1991 at 2.38 pm (Affects Fee Simple)
- C317674.5 Lease of Flat 2 Composite CT NA81C/429 issued - 25.10.1991 at 2.38 pm (Affects Fee Simple)
- C317674.6 Lease of Flat 3 Composite CT NA81C/430 issued - 25.10.1991 at 2.38 pm (Affects Fee Simple)
- Land Covenant in Lease C317674.6 - 25.10.1991 at 2.38 pm (Affects Fee Simple)
- C317674.7 Lease of Flat 4 DP 137673 Term 999 years commencing on the 30th September 1991 Composite CT NA81C/431 issued - 25.10.1991 at 2.38 pm (Affects Fee Simple)
- C317674.8 Lease of Flat 5 Composite CT NA81C/432 issued - 25.10.1991 at 2.38 pm (Affects Fee Simple)
- C317674.9 Lease of Flat 6 Composite CT NA81C/433 issued - 25.10.1991 at 2.38 pm (Affects Fee Simple)
- Land Covenant in Lease C317674.9 - 25.10.1991 at 2.38 pm (Affects Fee Simple)
- C440207.1 Variation of Lease C317674.5 - 15.12.1992 at 1.38 pm (Affects Fee Simple)
- C440207.2 Variation of Lease C317674.6 - 15.12.1992 at 1.38 pm (Affects Fee Simple)
- C440207.3 Variation of Lease C317674.7 - 15.12.1992 at 1.38 pm
- C440207.4 Variation of Lease C317674.9 - 15.12.1992 at 1.38 pm (Affects Fee Simple)
- 6524761.3 Mortgage to ANZ National Bank Limited - 8.8.2005 at 9:00 am

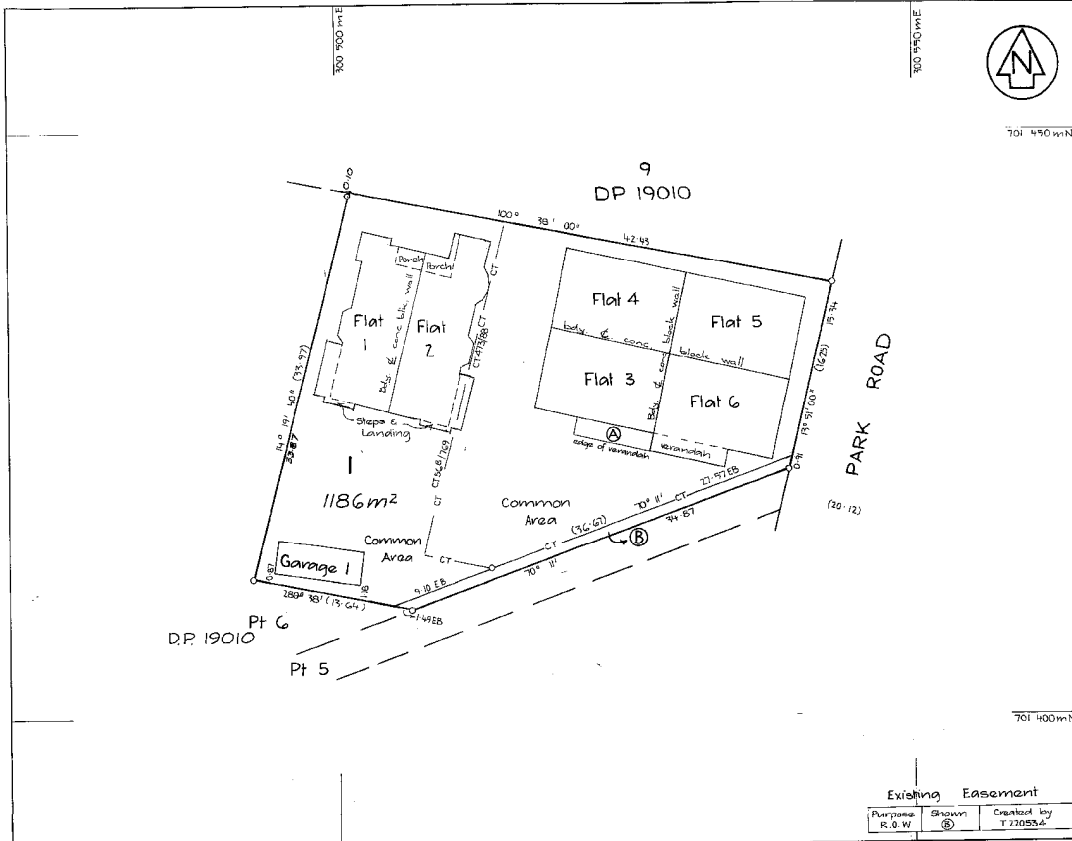

Approvals *[Signature]*

Registered Owners
 Pursuant to Sec 314 of the Local Government Act 1974 I hereby certify that the buildings depicted hereon were constructed before 1st April 1979 and were provided with such safeguards against fire and means of escape in case of fire as were required by the by laws of the Auckland City Council applying as at the date of the certificate.

Dated this *20th* day of *October* 1989

Planning & Inspection Manager
 Hanson & Easton Bay

Areas shown: **(A)**
 to be subject to restrictive covenants

Road shown is legal

Boundaries of areas to be leased are along the external face of exterior walls, structures and roofs unless otherwise shown

Restrictive covenants are not visibly defined unless otherwise shown

New Cot Allocated
 Flat 1 81F/428 Flat 4 81F/431
 Flat 2 81F/429 Flat 5 81F/432
 Flat 3 81F/430 Flat 6 81F/433

I Robert Glenn Ogilvie of Auckland registered surveyor and holder of an annual practising certificate hereby certify that the buildings shown hereon are erected in the position shown and are situated within the boundaries of DP 19010 and that the plan is correct.

Dated this *20th* day of *October* 1989

Signature *[Signature]*

Total Area **1186m²**

Comprised in All Cst 473/88 & 568/769

I, Robert Glenn Ogilvie of Auckland Registered Surveyor and holder of an annual practising certificate for who may act as a registered surveyor pursuant to section 28 of the Survey Act 1980/ hereby certify that this plan has been made from surveys executed by me or under my direction, that both plan and survey are correct and have been made in accordance with the Survey Regulations 1972 or any regulations made in substitution thereof.

Dated at Auckland this *20th* day of *October* 1989

Filed Book p. Reverse Book p.

Reference Plans

Examined Correct J. Lamberton

Approved as to Survey *[Signature]*
 Chief Surveyor

2 15 190

Deposited this *23* day of *October* 1989

ASST. District Registrar

DP137673

LAND DISTRICT North Auckland
 SURVEY BLK. & DIST. VIII Rangitoto
 NZMS 261 SHT RECORD MAP No Ak4344

Lot 1 & Flats 1-6 thereon being Pts
 Lot 6 DP19010

TERRITORIAL AUTHORITY Auckland City
 Surveyed by R.G. Ogilvie & Associates
 Scale 1:200 Date September 1989